

Bethell Utilities - CA0036 Camberwell Drive, OL7 9SN - One Way Closure

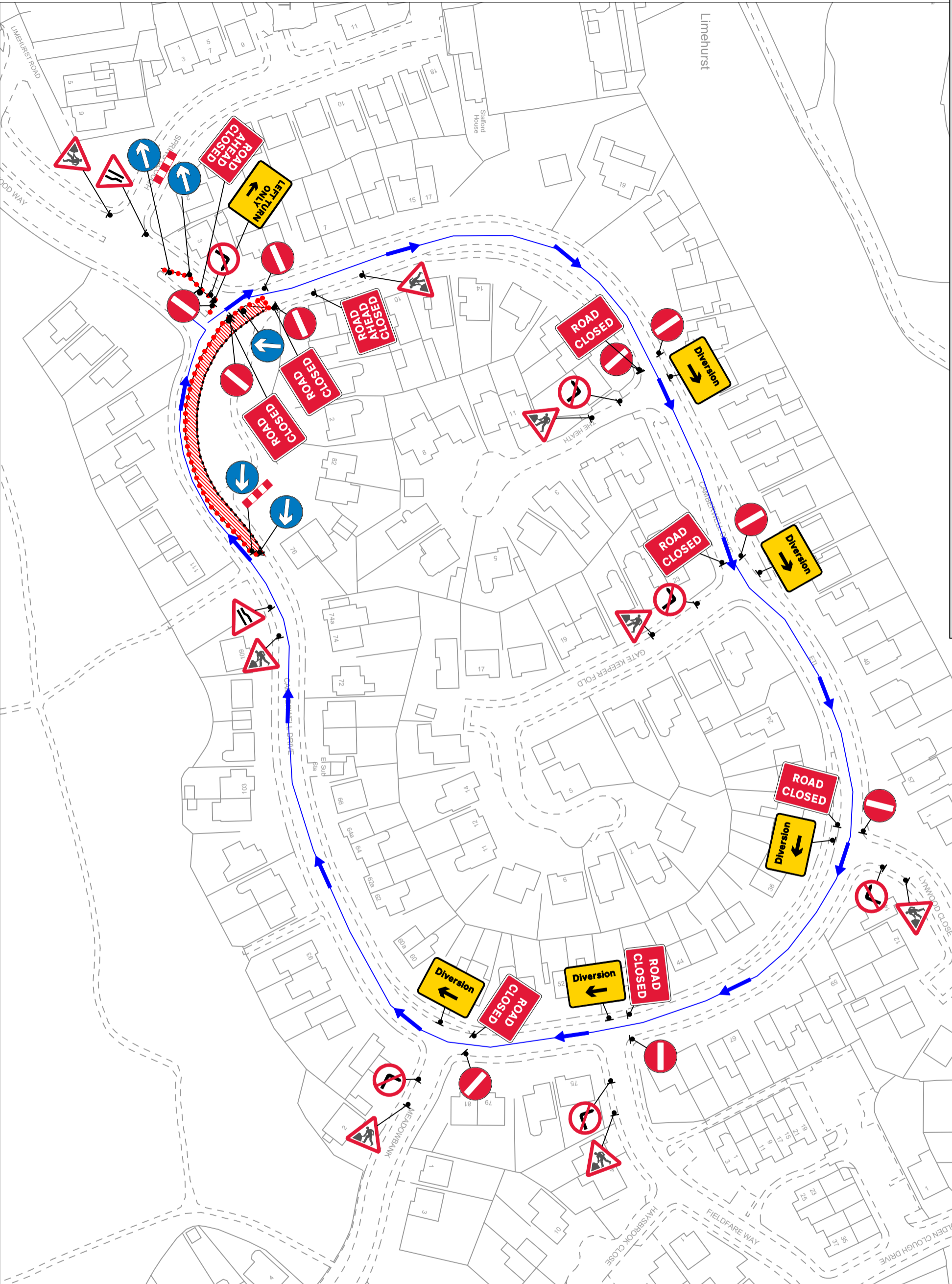

Client:

KEY.

Qty: 1		ROAD CLOSED
Qty: 3		ROAD AHEAD CLOSED
Qty: 2		DIVERISON
Qty: 2		LEFT TURN ONLY
Qty: 4		NO RIGHT TURN
Qty: 2		NO LEFT TURN
Qty: 4		NO ENTRY
Qty: 9		NO PEDESTRIANS
Qty: 8		NO MOTORISTS
Qty: 5		NO TRUCKS
Qty: 2		NO HEAVY GOODS VEHICLES

..... CONES

////// CLOSURE

--- PEDESTRIAN BARRIER

Bethell - CA0037 Camberwell Drive,
Ashton Under Lyne, OL7 9SN
One Way Road Closure

Drng No.

KHW.BTHU CA0036-200625.06v2

Drawn By: G Hargreaves

Checked By: S Hargreaves

A3
Not to scale
Dimensions: Metres

Date:

16/03/26

Notes:

This drawing has been produced for the client displayed and therefore not for use by any other company or persons for any other requirement.

- All signs follow chapter 8 requirements

- Distances are NOT to scale due to drawing purposes

- All placement of the TM equipment as stated per traffic management plan is to be adjusted to the layout and safety of the site aligning with the 'Safety at Street Works and Road Works - Code of Practice' & the 'Traffic Signs Manual Chapter 8.'